

# Landscape/ Estate Products



# Pulsar - Skidsteer (Hydraulic)



Flow Rates	Pack. Codes
14-17 GPM	A
18-20 GPM	B
20-22 GPM	B+
23-26 GPM	C
27-33 GPM	C+
33-40 GPM	D

The hydraulically driven Pulsar series was designed for mowing grass and light brush, up to 2" in diameter. Available in 60" and 72" cutting widths the skidsteer mount Pulsar can cut almost any desirable height.

The heavy 3/16" material deck and deck supports provide the durability for many years of dependable service. The front of the Pulsar features a push bar that bends tall grasses and brush under the deck. Our unique drive spindle is supported by 2 bearings allowing us to couple the hydraulic motor directly onto the drive spindle, eliminating the need for a gearbox.

With the standard 3 blades on the blade bar coupled with our unique float linkage, the Pulsar follows the contour of your cutting area.

Model (Hydraulic)	PRCH60	PRCH72
Shipping Weight (LBS.)	770	985
3PH Mount	NA	NA
Cutting Height	min 2"	min 2"
Cutting Path	60"	72"
Max Brush Diameter	2"	2"
Overall Width	66"	78"
Tip Speed (Ft/Min)	N/A	N/A
Acres/Hr (5 MPH)	2.73	3.27
Wheels (Segmented)	NA	NA
Blades (Qty.)	1/2" x 3" (3)	1/2" x 3" (3)
Hydraulic Requirement*	See Flow Rates	See Flow Rates
Deck	3/16	3/16
Stump Jumper	Yes	Yes
Protection	Relief Valve	Relief Valve

*\*To ensure optimum performance, hydraulic output must match motor package.*



The PTO powered Pulsar series of rotary cutters provide excellent mowing and shredding performance for tractors rated between 20-50 HP. The 3PH mount models are available in a variety of cutting widths, providing a cutting path from 48" - 72". To better adapt to your conditions, the Pulsar features an adjustable cutting height of 2" - 10" and a floating top link. This combination allows you to get the ideal cut for your field or roadside.

Model	PRC48LD	PRC48	PRC60	PRC66	PRC72	PRC72HD
<b>Cutting Path</b>	48"	48"	60"	66"	72"	72"
<b>Shipping Weight (LBS.)</b>	420	480	600	640	700	740
<b>Tractor HP (min)</b>	20	20	30	40	50	50
<b>3PH Mount</b>	CAT. 1	CAT. 1	CAT. 1	CAT. 1	CAT. 1	CAT. 1
<b>PTO RPM</b>	540	540	540	540	540	540
<b>Blades</b>	1/2" x 3"	1/2" x 3"	1/2" x 3"	1/2" x 3"	1/2" x 3"	1/2" x 3"
<b>Tip Speed (Ft/Min)</b>	13,100	13,100	12,462	13,708	14,955	14,955
<b>Wheels</b>	16" (Air Filled)			16" (Segmented)		

*The gearbox on the Pulsar Rotary Cutter is backed by a 5 Year Limited Warranty.*



**Segmented Wheel**



**Fixed Skid Shoe**



**Pulsar Blade Assembly**



**Floating Top Link**



**Slip Clutch**



**Chain Curtain Option**



# Pulsar Plus



The Pulsar Plus for tractors comes rated between 30 - 80 HP. This updated mower features not only Category 1, but also Category 2 and Quick Tach mounting options to fit your equipment. With a cutting path ranging from 60" - 120", and a cutting height of 2" - 10" with the standard floating top link, this mower will get the job done the first time. To ensure even cutting and shredding every time, the deck is outfitted with 3 blades covering more area on each pass.

Model	PRCPLUS60	PRCPLUS72	PRCPLUS84	PRCPLUS96	PRCPLUS120
<b>Cutting Path</b>	60"	72"	84"	96"	120"
<b>Shipping Weight (LBS.)</b>	700	865	1220	1475	1425
<b>Tractor HP (min)</b>	30-40	60	60	80	80
<b>Hitch Type</b>	CAT. 1 & 2 Quick Tach compatible				Draw Bar Hitch
<b>PTO RPM</b>	540	540	540	540	540
<b>Blades</b>	3 - 1/2" x 3"	3 - 1/2" x 3"	3 - 1/2" x 3"	3 - 1/2" x 3"	6 - 1/2" x 4"
<b>Tip Speed (Ft/Min)</b>	12,462	15,260	17,803	16,500	14,500
<b>Wheel Type (Qty.)</b>	16" Segmented (1)	16" Segmented (1)	16" Segmented (2)	16" Segmented (2)	16" Pneumatic (2)

*The gearbox on the Pulsar Rotary Cutter is backed by a 5 Year Limited Warranty.*



**Segmented Wheel**

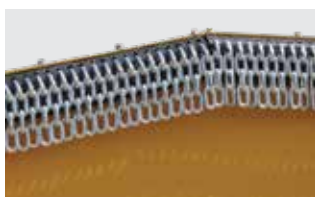

**Chain Curtain Option**



**Blade Assembly**



**Floating Top Link**



**Slip Clutch**



**Bolt-On Skid Shoe**



MK Martin presents the Pulsar Wing. Available in a 15' model, the three triple blade assemblies make short work of stubble — whether in the pasture, field, or brush. Each wing can independently float 20° in either direction to conform to the contours of the ground. The 15' width of the cutter can be greatly reduced by folding up both hydraulic wings to better transport from one field to another, and to store the cutter in tight spaces.

## Features & Options

- 15' dual wing rotary cutter
- 4 heavy duty gearboxes, each covered with 5 year limited warranty
- Transport lock for each wing
- 1.5" diameter cutting capacity
- Each wing can float to conform to ground contours



# Pulsar Wing



Model	PW180
Shipping Weight (LBS.)	4,400
3PH Mount	Draw Bar Hitch
Cutting Height	3"-15"
Cutting Path	180"
Max Brush Diameter	1.5"
Overall Width (Wings Down)	184"
Folded Width (Wings Up)	78"
Tip Speed (Ft/Min)	15,100 ft/min on Wings 14,850 ft/min on center
Wheels (Pneumatic)	21"
Blades	9 blades 1/2"x4"
Tractor HP (min)	75HP
PTO RPM	540
Gearbox Rating (Wing)	140 HP
Gearbox Rating (Center)	105 HP
Gearbox Rating (Divider)	87 HP
Deck	3/16"
Stump Jumper	Yes
Protection	Independent Slip Clutch on Each Spindle





# Pulsar - Finishing Mower



The Pulsar Finishing Mower is available for a wide variety of lawn mowing applications. Available in four sizes, there is a size to fit your mowing needs. Riding on four solid rubber tires, the Pulsar Finishing Mower floats smoothly over your lawn without worry of flat tires. A floating top link ensures that all four wheels keep contact with the ground as your 3PH equipped tractor pulls it along.

Model	PFM48RD	PFM60RD	PFM72RD	PFM90RD
Cutting Width	48"	60"	72"	90"
Overall Width	50"	62"	74"	93"
Weight (LBS.)	370	435	525	714
Acres/Hr@5 MPH	2.43	3.03	3.63	4.57
HP Required	14/20	20/25	25/30	30/40
3PH Mount	CAT. 1	CAT. 1	CAT. 1	CAT. 1
RPM @ PTO Shaft	540	540	540	540
Number of Blades	3	3	3	5
Tip Speed (Ft/Min)	15,660	18,000	16,850	16,288
Wheels	Solid Rubber Wheel	Solid Rubber Wheel	Solid Rubber Wheel	Solid
Cutting Height	2" - 5"	2" - 5"	2" - 5"	2" - 5"

*The gearbox on the Pulsar Rotary Cutter is backed by a 5 Year Limited Warranty.*



**Blade Assembly**

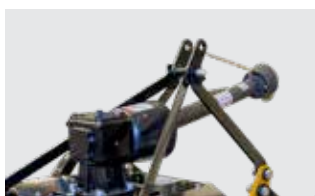

**Floating Top Link**



**Solid Rubber Wheel**



**Adjustable Height**



**Rear Discharge Shield**



**Optional Chain Guard**



This rough cutting mower is built for creating and maintaining trails, managing your open fields, and for improving wildlife habitats before plowing and reseeding

## Features & Options

- 44" Cutting Width
- 19HP Briggs & Stratton
- 12 Volt electric start
- Remote e-Stop
- 2 Rotors with 3 blades each
- Adjustable cutting height (2"-7") with ratchet style adjustment
- 3 position hitch for straight or offset cutting
- Flat free tires
- Swivel wheels on front, fixed wheels on rear

# UTV Mower



Model	PTM48
Engine Brand	Briggs & Stratton
Engine HP	19
Starting System	Key (electric)
Fuel Tank	3 Gal.
Battery	12 Volt
Deck	Rear Discharge
Deck Thickness	10 ga
Blade Assembly	2 Rotors with 3 Blades each
Cut Width	44"
Cut Height	2" - 7"
Wheels	14 x 6
Weight	720 lbs



The Axis Tool Arm has been developed to provide an economical alternative for mowing road side ditches or along side fences. Offset design allows plenty of room to clear the tractor tires, as well as keeping the tractor on a more level surface. Should you hit a solid object with the outer edge of the tool attached to the arm, the Axis Tool Arm is equipped with shear bolt protection on a breakaway link. With a 55° cutting angle with the cylinder extended, and 90° cutting angle with the cylinder retracted, the operator has ample flexibility to match whatever terrain they are working with.

Model	AXIS4	AXIS5-6
<b>Weight (LBS.)</b>	751	900
<b>Offset</b>	60"	84"
<b>3PH Mount</b>	CAT. 1	CAT. 1 & 2
<b>Minimum Tractor Weight (LBS.)</b>	2,900	5,800
<b>Maximum Tool Weight (LBS.)</b>	480	800
<b>4' Rotary Cutter (Not Included)</b>	req. min. 30 HP	
<b>5' Rotary Cutter (Not Included)</b>	req. min. 60 HP	
<b>6' Rotary Cutter (Not Included)</b>	req. min. 80 HP	
<b>Cutting Angle Cyl. Ext.</b>	55°	
<b>Cutting Angle Cyl. Ret.</b>	90°	
<b>Tractor Remotes Req.</b>	2	
<b>Protection</b>	Shear Bolt	Shear Bolt



## Hydraulic Tool Lift

The Axis Tool Arm hydraulically pivots on your 3PH raising and lowering the tool as needed. With the Axis fully raised the mower can be folded in to provide safe road travel (image below).



## Hydraulic Tool Rotation

To provide the best results when mowing along ditches or around ponds, the tool carrier is hydraulically adjustable allowing mower adjustments to match the terrain grade.

## Stabalizer Arm to Cutter

Various attachment bracket are supplied with the Axis Toolbar to attach the Stabilizer Bar to the cutter. All four adaptors are included.

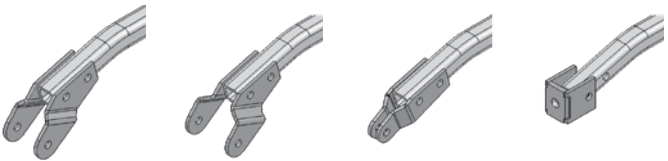

**Shown in order:** Pulsar, Kodiak, Fork Rear Wheel Style with 180° Wheel Adjuster, Fork Rear Wheel Style with Flat Wheel Adjuster



**Transport Lock**



**Retractable Weight Bar**



## 3PH Box Blade



The 3PH Box Scraper designed by MK Martin provides owners of small and large properties affordable options for land grading. Complete with steel cutting edges, height adjustable shanks, quick hitch compatibility, and a fully welded 3PH design, these Box Scrapers deliver impressive results.

The MK Box Scraper features two steel cutting edges. One is located on the inside of the box and the second is on the outside. These two reversible hardened steel cutting edges allow the operator to pull or push material.

### Height Adjustable & Replaceable Scarifier Tips

The height adjustable ripper shanks break up the soil allowing the cutting edge to redistribute the material as the box scraper is pulled along. Removeable shanks feature replaceable scarifier tips.

Model	Width	Shanks	Mouldboard	End Plates	3PH Mount	Weight (LBS.)
<b>448 STD</b>	4'	4	3/16"	1/4"	CAT. 1	308
<b>560 STD</b>	5'	4	3/16"	1/4"	CAT. 1	348
<b>566 HD</b>	5'6"	5	3/16"	1/4"	CAT. 1	415
<b>672 HD</b>	6'	6	3/16"	1/4"	CAT. 1	450
<b>784 HD</b>	7'	7	3/16"	1/4"	CAT. 1	500
<b>784 DLX</b>	7'	7	1/4"	1/4"	CAT. 2	555
<b>896 DLX</b>	8'	8	1/4"	1/4"	CAT. 2	612

# Track Curry



Groom your track or arena surface with the MK Martin Track-Curry. This easy to use tool will allow conditioning of track surfaces to your desired firmness. With two rows of heavy duty S-tines to cultivate the ground, an adjustable leveling bar fastened to the rear of the S-tines, and a 12" rolling drum behind the leveling bar, the Track-Curry provides an accurate depth gauge to cultivate and pack your soil for optimum performance. The MK Martin Track-Curry will condition your arena or track to the footing most suited for the health and safety of your horses.

## Spill Plates    Optional Wing    Scarifier Bar    Sprinkler Kit



Model	TC-5	TC-6	TC-7	TC-8
<b>Working Width</b>	5'	6'	7'	8'
<b>Number of Shanks</b>	13	15	17	19
<b>Shank Size</b>	1-1/4" x 3/8" x 22"			
<b>Shank Clearance</b>	16"	16"	16"	16"
<b>3PH Mount</b>	CAT. 1	CAT. 1	CAT. 1	CAT. 1
<b>HP Rating</b>	18 - 32	22 - 39	26 - 47	30 - 53
<b>Weight (LBS.)</b>	460	530	640	725
<b>Leveling Bar</b>	1/2" x 6" (double beveled)			





# Light Duty Grader Blade



*MKGN467 shown*

## Features

- Five Stops of angle adjustment (Forward and back)
- Manual angle adjustment
- 3/16" Mouldboard
- 3/8" x 6" reversible cutting edge
- Quick hitch compatible

Model	MKGB467	MKGB567	MKGB667
Horsepower	30 HP	30 HP	30 HP
Hitch		CAT 1.	
Width (in.)	48"	60"	72"
Weight (lbs.)	140	149	155
Reverse		Yes	
Mouldboard		3/16" Material	
Cutting Edge		3/8" x 6" Reversible	
Angle (Control)		Yes (Manual)	
Angle (Position)		5 Stops Forward / 5 Stops Reversed	

# Grader Blade



*Shown with optional Hydraulic Angle blade*

The 3PH Grader Blade from MK Martin makes maintaining your driveway and gravel areas easy. Ruggedly built with a reversible cutting edge, these blades are designed for years of service.

The Manual Blades have five stops of angle adjustment including a full turn around, while the optional Hydraulic Angle blades allow control of the blade from the comfort of your seat. With widths to match your equipment and property, there is an MK Scraper blade to help keep your grades up.

## Features

- 1/2" x 6" reversible cutting edge
- Full turn around with five locations forward and reverse on manual only
- 3/8" mouldboard - 98 series
- Hydraulic Angle (optional)
- Quick hitch compatible

Model	Max. HP	Width	Mouldboard	Center Pin	3PH Mount	Weight (LBS.)
<b>MKGB588</b>	45	5'	3/16"	2"	CAT. 1	180
<b>MKGB688</b>	45	6'	1/4"	2"	CAT. 1	200
<b>MKGB788</b>	45	7'	1/4"	2"	CAT. 1	215
<b>MKGB798</b>	75	7'	3/8"	3"	CAT. 2	577
<b>MKGB898</b>	75	8'	3/8"	3"	CAT. 2	616



## Extreme Duty Grader Blade for 100-150 HP Tractors

The Extreme Duty Grader Blade from MK Martin mounts to your 3-point tractor hitch. Powered by the hydraulics of your tractor, the XD series blade has hydraulic cylinders to adjust the offset of the arm, blade angle, and tilt of the blade. An additional hydraulic cylinder on the optional wheel kit helps with depth control.

The Extreme Duty grader blade is available in 8', 9' and 10' models for tractors with a rated horsepower of 100 and 150 HP.

Available options include dual gauge wheel kit with hydraulic cylinder.

### Features



**Hydraulic Angle**



**Hydraulic Tilt**



**Hydraulic Offset**

# XD Grader Blade



Model	8XD-100	9XD-100	9XD-150	10XD-150
Horse Power (Max.)	100	100	150	150
3PH Mount	CAT. 2 & 3			
Mouldboard Thickness	5/16"			
Mouldboard Width	96"	108"	108"	120"
Mouldboard Height	20"			
Offset Adjustment	27" left or right (hydraulic)			
Adjustment Angle	32° left or right (hydraulic)			
Adjustment Tilt	13° blade adjustment (hydraulic)			
King Pin	3-1/2"	3-1/2"	4"	4"
Cutting Edge	High Carbon 1/2" x 6" (reversible)			
Weight (LBS.)	1,572	1,666	1,695	1,745





# Grader Leveler



This two-in-one combination of leveling and scraping makes short work of your grading jobs. The first blade attacks the high spots cutting them down to size and the second blade further scrapes anything the first missed and fills in the hollows. With two blades cutting and filling it takes much less time and fewer passes to achieve the even distribution of material you are looking for.

The scraper can be 3PH mounted, or equipped with a skidsteer adapter plate to keep the work in front of you.

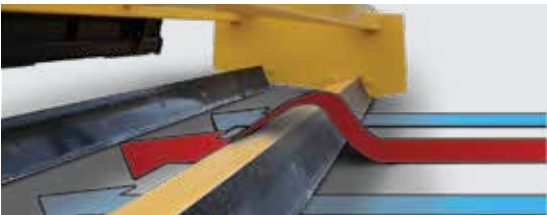

Model	GL578	GL678	GL778	GL878
<b>Working Width</b>	60"	72"	84"	96"
<b>Overall Width</b>	65"	77"	89"	101"
<b>Skid Shoes</b>	3/8" x 2 Reversible	3/8" x 2 Reversible	3/8" x 2 Reversible	3/8" x 2 Reversible
<b>Mouldboard Thickness</b>	1/4"	1/4"	1/4"	1/4"
<b>Cutting Edge</b>	1" Adjustment	1" Adjustment	1" Adjustment	1" Adjustment
<b>Weight (LBS.)</b>	566	630	696	760

# Land Plane



Designed to revive your laneway or gravel lots, the Land Plane provides acreage owners with a single tool to tear up hardpack, fill potholes, and grade for a smooth, desirable finish.

The Land Plane is available in 72", 84", and 96" widths giving operators the ideal working widths for their compact and utility tractors.



Two hydraulic cylinders power the scarifier bar deep below the surface, loosening the hard pan and pulling the material to the surface where it can be redistributed. The hydraulic control allows the operator to adjust pressure on-the-fly to compensate for the changing ground conditions without having to leave the operator's seat.

The Land Plane is available in either skid loader or 3PH mounts.

Model	LP678	LP778	LP878
<b>Working Width</b>	72"	84"	96"
<b>Overall Width</b>	77"	89"	101"
<b>Length</b>	69.5"	69.5"	69.5"
<b>Shank (Qty.)</b>	6	7	8
<b>Shank Tube</b>	4" x 6" x 1/4"		
<b>Cutting Edge (x2)</b>	Hardened 1/2" - Reversible 1" Adjustments		
<b>Skid Shoes</b>	3/8" x 2 Reversible		
<b>Cylinder</b>	Dual Hydraulic Cylinders for shank rotation		
<b>Weight (LBS.)</b>	1,140	1,240	1,350



# Land Leveler



These rugged scrapers come in a range of sizes from 8'-12' to fit your needs and equipment. Standard on all models is our 1/2" thick reversible hardened cutting edge, ready to smooth out the bumps and fill in the hollows. Cutting depth is controlled by a 3"x12" hydraulic cylinder so you can decide how much of a bite to take and adjust on the go. All models are well suited for feedlot and soil reclamation or swale cutting.



Model	LLT-8	LLT-10	LLT-12
Width	8'	10'	12'
Mount	Hitch	Hitch	Hitch
Tilt	Yes	Yes	Yes
Cutting Edge	Single	Single	Single
Side Plate	3/8"	3/8"	3/8"
Mouldboard	1/4"	1/4"	1/4"
Wear Plate	NA	NA	NA
Skidbar	1/2" Reversible	1/2" Reversible	1/2" Reversible
Weight	1555	1771	1898

# Land Leveler

## Features

- 1/2" x 6" reversible hardened cutting edge
- Equipped with a 10" jack or 15" available on request
- 3" x 12" hydraulic lift cylinder
- 3" x 6" cylinder to tilt 10° each way



**Adjustable Skid Bars**



**Tilt Indicator**



**Transport Lock**



LLP-8	LLP-10	LLP-12	LLP2-8	LLP2-10	LLP2-12
8'	10'	12'	8'	10'	12'
3PH	3PH	3PH	3PH	3PH	3PH
NA	NA	NA	NA	NA	NA
	Single			Double	
3/8"	3/8"	3/8"	3/8"	3/8"	3/8"
1/4"	1/4"	1/4"	1/4"	1/4"	1/4"
3/4"	3/4"	3/4"	3/4"	3/4"	3/4"
NA	NA	NA	NA	NA	NA
838	956	1077	945	1090	1238





# Rotary Tiller (3PH)



## Features & Options

- Replaceable Bolt-On Tines
- Self Lubricating Chain Drive
- Adjustable Skidshoes
- Floating Deflector
- Gear Box
- 3PH Mount Offset
- Slip Clutch

Models	RT486	RT546	RT606	RT726
<b>Horsepower</b>	15-30 HP	20-40 HP	20-50 HP	25-60 HP
<b>Hitch</b>	CAT. 1	CAT. 1	CAT. 1	CAT. 1
<b>Inner Width (in.)</b>	50	54	58	74
<b>Overall Width (in.)</b>	55.375	59.375	63.375	79.375
<b>Weight (lbs.)</b>	475	482	500	575
<b>Number of Flanges</b>	6	6	7	9
<b>Tines/Flange</b>	6 (C-Shape)	6 (C-Shape)	6 (C-Shape)	6 (C-Shape)
<b>Flange Spacing (in.)</b>	7.75	7.75	7.75	7.75
<b>Max Tillage Depth (in.)</b>	6.5	6.5	6.5	6.5
<b>Number of Skid Shoe Settings</b>	5	5	5	5
<b>Rotor Diameter (in.)</b>	17"	17"	17"	17"
<b>Rotor Speed @ 540 PTO (RPM)</b>	211	211	211	211
<b>Gearbox (HP)</b>	50HP @ 540	50HP @ 540	50HP @ 540	50HP @ 540
<b>Drive Chain</b>	#80	#80	#80	#80

# Rotary Tiller (Hydraulic)



Prepare your seedbed or garden for planting using the MK Martin Rotary Tiller. With standard features such as adjustable skidshoes, floating deflector, replaceable tines, and an oil bath drive chain, this tiller easily loosens soil for a variety of applications.

Available in a range of sizes, there's an MK Rotary Tiller for any application.

Models	RT726H
Horsepower	NA
Hitch	Skid steer attachment plate
Inner Width (in.)	74
Overall Width (in.)	79.375
Weight (lbs.)	575
Number of Flanges	9
Tines/Flange	6 (C-Shape)
Flange Spacing (in.)	7.75
Max Tillage Depth (in.)	6.5
Number of Skid Shoe Settings	NA
Rotor Diameter (in.)	17"
Rotor Speed @ 540 PTO (RPM)	NA
Gearbox (HP)	NA
Drive Chain	#80

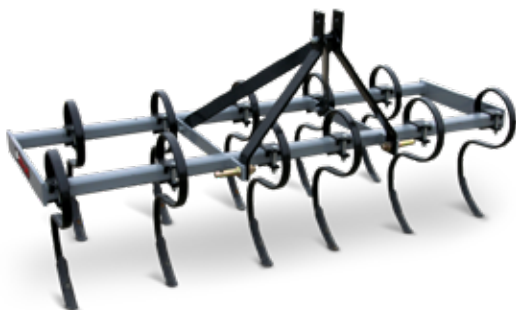

This line of economy cultivators is ideal for cultivating small fields and gardens.

Model	CU-5	CU-6	CU-7
<b>Working Width</b>	60"	72"	84"
<b>Overall Width</b>	60-1/2"	72-1/2"	84-1/2"
<b>Weight (LBS.)</b>	164	193	222
<b>Tines (Heat Treated)</b>	9 tines	11 tines	13 tines
<b>3PH Mount</b>	CAT. 1	CAT. 1	CAT. 1

## Landscape Rake

### Features

- 5 forward and 3 reverse positions with manual adjustment
- 5/16" x 1" x 15.25" spring tines
- CAT. 1 Quick Tach compatible



Model	MKLR5	MKLR6	MKLR7
<b>Width</b>	5'	6'	7'
<b>MAX HP</b>	50	50	50
<b>Weight (LBS.)</b>	250	263	285
<b>Tines</b>	30	36	42

# Dump Box



This general purpose 3PH Utility Dump Box comes in two sizes for the home owner, landscaper or wood lot owner.

- 3PH hookup CAT. 1
- Quick and easy dump
- Raise and lower to desired height for loading
- Heavy duty tubular sub frame
- 14 GA. material box structure

Model	Cap	Size	Weight (LBS.)
<b>DB495</b>	30 cu ft	18" x 48" x 48"	290
<b>DB395</b>	10 cu ft	10" x 36" x 36"	120





## 3PH Weight Box



With an internal material holding volume of 3.5 cubic feet and maximum holding weight capacity of 525 lbs, this weight box can add up to 575 lbs of balancing weight to your CAT. 1 3PH. This added weight backs up your tractor by offsetting your loader mounted attachments, helping to keep your tractor safely balanced during operation. This weight box has a tool holder, clean out hatch, and a 2" hitch receiver.

Specifications	MKWB
Hitch Type	CAT. 1
Box Volume	3-1/2 cu ft
Max Weight (box and fill) (LBS.)	575
Max Weight (fill only) (LBS.)	525
Quick Hitch Compatible	Yes

Fill Type	Weight Per Cubic Foot (lbs.)
Concrete	150
Gravel	110
Sand	100

