



Individual Round and Square Bale Wrappers  
RW / SW SERIES



## FAST, EFFICIENT AND RELIABLE

YOUR FEED DOLLARS COUNT. PROTECT YOUR BOTTOM LINE BY PRESERVING FEED QUALITY AT ITS OPTIMUM POTENTIAL WITH KUHN WRAPPERS. KUHN OFFERS THE MOST COMPLETE AND VERSATILE RANGE OF INDIVIDUAL WRAPPERS AVAILABLE ON THE MARKET. FROM STATIONARY ROUND BALE WRAPPERS TO TRAILED LARGE SQUARE BALE WRAPPERS, ALL KUHN WRAPPERS PRODUCE CONSISTENT, HIGH-QUALITY WRAPPED BALES TO HELP MAINTAIN OPTIMUM FORAGE QUALITY THROUGHOUT THE STORAGE PERIOD.



### UNMATCHED RELIABILITY

KUHN brings cost efficient, ecological and ergonomic bale wrapping solutions with a complete range of reliable round and square bale wrappers. KUHN wrappers are designed to perform under all circumstances.

### KEEPING AHEAD WITH NEW INNOVATIONS

KUHN continually strives to improve its round and square bale wrappers with innovations like IntelliWrap, AutoLoad and e-Twin technology.

### Summary

**Fast and Reliable Wrapping** .....4-5

**eTwin Technology** ..... 6

**RW 1110** ..... 7

**RW 1410** ..... 8

**RW 1610** ..... 9

**SW 1114** .....10-11

**SW 1614** ..... 12

**SW 4014** .....13-15

**Electronics** ..... 16

**Specifications** .....17-19

Models	Round Bales	Square Bales
<b>RW 1110</b>	4' x 5' (1.22 x 1.5 m)	
<b>RW 1410</b>	4' x 5' (1.22 x 1.5 m)	
<b>RW 1610</b>	4' x 5' (1.22 x 1.5 m)	
<b>SW 1114</b>	5' x 5' (1.5 x 1.5 m)	2' x 3' (.60 x .90 m) & 3' x 3' (.90 x .90 m)
<b>SW 1614</b>	5' x 5' (1.5 x 1.5 m)	2' x 3' (.60 x .90 m) & 3' x 3' (.90 x .90 m)
<b>SW 4014</b>	5' x 5' (1.5 x 1.5 m)	2' x 3' (.60 x .90 m), 3' x 3' (.90 x .90 m), 3' x 4' (.90 x 1.20 m), 4' x 4' (1.20 x 1.20 m)

# FAST AND RELIABLE WRAPPING

KUHN bale wrappers' unique features make them stand out from the competition. The pre-stretchers, film cutters, wrapping table and low-profile chassis design make KUHN bale wrappers simple, easy-to-use, fast and efficient.

## FILM CUTTERS

Once the desired number of film layers have been applied, the film is held firmly and cut. On the turntable wrapper models, a spring-loaded or hydraulic high-grip film cutter holds and cuts the film automatically without the need for extra controls. On KUHN satellite wrappers, the well-known "scissor-type" cutters hold and cut the film. Due to its design, the film is caught across the full width. The film is held with a clamp, gathered into one solid rope and then cut before the bale is unloaded. The clamp firmly holds the film ready for the next bale.



## ROUND BALE TURNTABLE

The KUHN round bale turntable wrappers are equipped with two rollers and four wide-spaced belts. This design provides a deep and stable cradle for the bale on the wrapping turntable. The two large bale support rollers provide more stability and guidance. The four wide-spaced belts provide maximum traction and even rotation for the bale. Even bale rotation is vital to ensure the optimal film overlap for proper conservation and crop quality during storage.

## SQUARE BALE TURNTABLE

The KUHN large square bale turntable wrappers are equipped with two pairs of steel rollers with a ribbed profile. This profile ensures maximum bale traction, even bale rotation and proper film overlap. Two large bale support rollers provide additional stability and guidance. Round bales can also be wrapped with these wrappers.



## CONTROL SYSTEMS

Two different control systems are available dependent on model and driver preferences:

- **The manual version (M)** is controlled with cable levers, and comes standard with the bale-and-wrap counter and autostop. The bale-and-wrap counter counts the film layers and total number of wrapped bales. The autostop function will automatically stop the wrapping table once the total number of film layers have been applied. This enables semi-automatic wrapping, even with manual controls.

- **The computer-controlled version (C)** uses a color touchscreen VT30 to provide all the information and features of fully automatic wrapping. A remote control system is available for certain wrappers (see specifications page).

M



C



Remote control

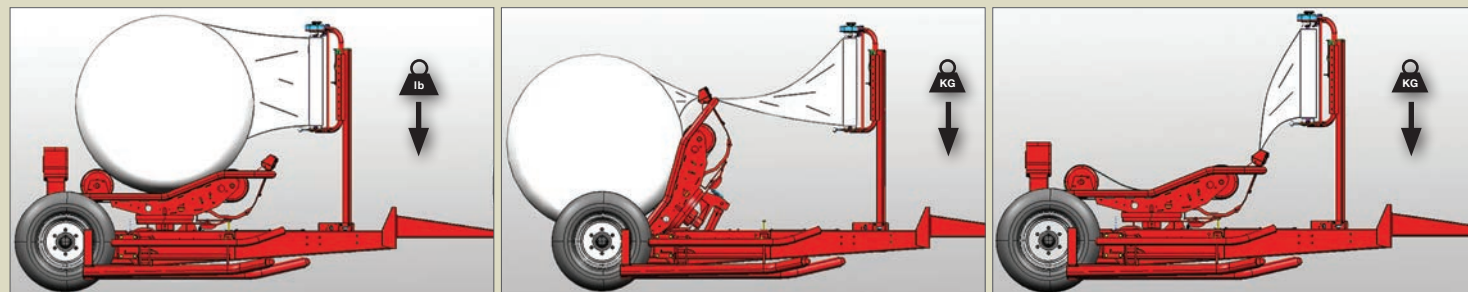

## LOW-PROFILE CHASSIS DESIGN

The KUHN trailed turntable wrappers have a unique low-profile design ideal for stability when loading, wrapping or unloading a bale. The rear axle position results in a low table height, eliminating the need for an active fall dampener. There is constant weight transfer to the tractor, which prevents up-and-down movements of the drawbar and to prevent tractor wheel slippage when driving uphill with a bale on the table or loading arm. The bale can be dropped on the go for maximum output!

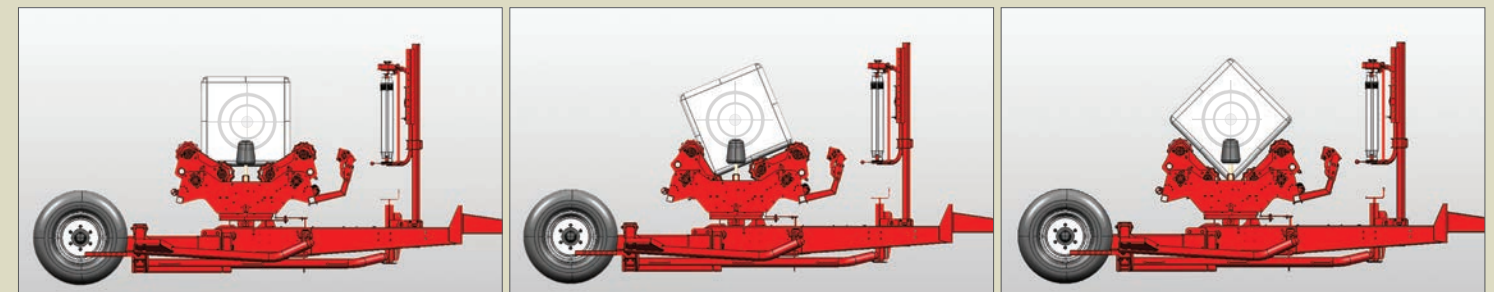

## SQUARE TURNTABLE MODELS

The two pairs of adjustable steel rollers ensures even bale rotation and optimal wrapping no matter the bale size.



**RW 1110**

## 3-POINT MOUNTED ROUND BALE WRAPPER

The RW 1110 is ideal for "wrap and stack" operations in the field or in the yard, with the ability to wrap bales as heavy as 2,645 lbs (1,200 kg). Wrapping at the storage location reduces the risk of film damage. The RW 1110 is available in M and C versions and is well-suited for a one-person wrapping operation.

### HEAVY-DUTY, USER-FRIENDLY

The RW 1110 is capable of wrapping heavy bales up to 2,645 pounds (1,200 kg) due to its reinforced large main frame, standard for all stationary wrappers. The low mounted four-belt turntable ensures a gentle bale discharge so there is no need for an active fall dampener. The low height also allows easy replacement of the film rolls. For a firm cut and hold of the film, even in wet conditions, the wrapper has a spring-loaded high grip film cutter. For even more convenience, the RW 1110 is quick hitch compatible.



### TRAILER KIT

The trailer kit option provides simplicity and easy transport for stationary wrappers. This kit allows the machine to be used as a self-contained wrapping unit or attached to a tractor, providing flexibility to match your unique needs. The standard engine platform makes it easy to add an optional KUHNS power pack (HPU 114) for a completely self-contained machine.



### SUPPORT LEGS

Optional on the RW 1110, extra wide support legs increase stability during free-standing operation.



### FOUR-ROLL FILM

Optional four-roll film magazine is available for additional storage on the machine.

**RW 10 SERIES**

## e-Twin TECHNOLOGY

Besides standard single stretch, KUHN offers the innovative e-Twin system for excellent, economical, and fast wrapping on the RW 10 series. The innovative e-Twin technology enables wrapping via an innovative combined pre-stretcher design with unique film distribution to save 50% on wrapping time and additional film savings.



### UNIQUE ADVANTAGES OF e-Twin:

- Save 50% wrapping time
- Reduce film use with increased pre-stretch ratio
- Tighter wrapped bales seal more effectively for higher quality feed
- Extreme tear resistance
- Available on manual and computer versions



### PRE-STRETCHERS

The conical pre-stretch rollers have been positioned in such a way that the two 30" (750 mm) film rolls with 2/3 overlap are stuck together, providing a double layer before they leave the pre-stretcher unit. Optional on some of the wrappers is the auto film layer correct kit. The correct kit detects an empty or torn film roll and adjusts the amount of table rotations to cover the bale with the target layers using only one roll of film.

### CURIOS HOW KUHN e-Twin TECHNOLOGY MAKES YOUR WRAPPING BUSINESS MORE PRODUCTIVE AND COST EFFICIENT?

Calculate your yearly savings by using our e-Twin calculator found at [www.kuhn.com](http://www.kuhn.com). Select your language and country. From the *Services & Parts* menu, select *Hay & Forage apps > e-Twin Calculator*



BALE INFORMATION		HANDLING INFORMATION	
Bale diameter (cm)	100	Number of layers	5
Bale width (cm)	120	Film per roll (m)	1500
Bales per year	3000	Price per roll (€)	75
		Tractor cost (€)	25
		Labor cost (€)	30
		Single wrap pre-stretch (%)	75
		e-Twin wrap pre-stretch (%)	90





**RW 1410**

## TRAILED, SELF-LOADING ROUND BALE WRAPPER

The mid-range RW 1410 will lift bales up to 5' (150 cm) in diameter and 2,200 pounds (1,000 kg), due to its unique low-profile chassis design with wide-track wheels. The design of the RW 1410 has a wrapping table with four belts, stronger frame and high grip film cutter for optimal results. Available in M or C versions.



### RIGHT-HAND WHEEL

The right-hand wheel can be folded inwards, reducing transport and storage width while offering a wider track for field stability.

### BALE TURNER

The optional bale turner, features a hydraulic arm allowing the bale to be discharged on to its flat end. An optional left hand side support prevents the bale from rolling downhill.



**RW 1610**

## TRAILED, SELF-LOADING ROUND BALE WRAPPER

The professional RW 1610 round bale wrapper, with the ability to wrap bales up to 2,650 pounds (1,200 kg) and 5' (150 cm) in diameter, is ideal for those wrapping operations where high capacity and high efficiency are required. Due to its strong design with low table height and standard large wheels located at the rear, there is no need for an active fall dampener. This saves extra process steps and the bale can be unloaded on the go. The RW 1610 is equipped with a standard high grip film cutter and film roll holder for two rolls. Available in M or C versions.

### AUTOLOAD

The KUHN RW 1610 can load and carry a second bale in the loading arm during wrapping. Constant weight transfer towards the tractor helps prevent slippage in hilly circumstances. The C model, with integrated AutoLoad function has increased overall loading, wrapping capacity, and efficiency. The AutoLoad function enables the operator to fully concentrate on the driving process, while the wrapping process is automatically started once the bale has been detected on the loading arm. Picking up a second bale for transport during wrapping is fully automated as well.





## 3-POINT MOUNTED LARGE SQUARE AND ROUND BALE WRAPPER

The SW 1114 is a 3-point mounted, quick hitch compatible bale wrapper that can wrap large square bales and round bales up to 2,645 lbs (1,200 kg). The large, strong main frame has two pairs of steel rollers that provide a deep cradle for the bale and even rotation to ensure proper film overlap. The bale can be gently discharged because of the low mounted turntable. Available in M or C versions.

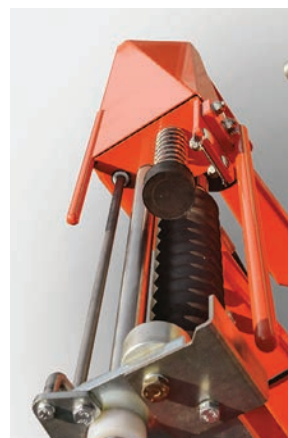

### FILM CUTTER

A hydraulic, high-grip film cutter allows you to adjust the cutting movement independent of the table tipping position, resulting in the shortest possible end-string. It has a long stroke to help accommodate various bale lengths and ensures a firm hold and a clean cut of the film in various weather conditions.



### PRE-STRETCHER

The standard pre-stretchers, which hold a 30" (750 mm) roll, are made of aluminum to avoid build-up of tack from the film. Both outer ends of the aluminum rollers are cone-shaped to maintain the optimum width of the film and reduce the risk of film tear. The special ribbed profile of the aluminum rollers keeps air and water away from the film. The location of the pre-stretchers makes it easy to change the film rolls. The standard pre-stretch of 70% is reached by a low-maintenance and low-noise gear transmission. An optional 60% pre-stretch gear kit can be installed to change the standard pre-stretch to 60% to adapt to difficult wrapping conditions.



### POWER PACK

Mounted wrappers can be run using a KUHN HPU 114 power pack engine, rather than a separate tractor. The trailer and engine allow one person to load and wrap bales without the need for a second tractor or an additional operator, simplifying the logistics of the wrapping operation.



**SW 1614**

## TRAILED, SELF-LOADING ROUND AND LARGE SQUARE BALE WRAPPER

The SW 1614 is a hybrid bale wrapper that can wrap large square bales 2x3 or 3x3 (80x60-90 cm) up to 6' (180 cm) in length, and round bales up to 5' (150 cm) in diameter. Due to its unique low-profile chassis design with wide track wheels, a second bale can be carried during wrapping to increase overall efficiency. Available in M or C versions.



### INTEGRATED AUTOLOAD

Featured on the C version, once the bale is detected on the arm, all the wrapping steps are automatically executed.



### LOW TABLE HEIGHT

Allows the bale to be gently tipped off to prevent film damage, without the need for a fall dampener. The low machine height also allows easy replacement of the film rolls.



### ROAD TRANSPORT

The wheels can be folded inward to reduce the transport width. Hydraulic folding is optional.

**SW 4014**

## TRUE WRAPPING INTELLIGENCE



The KUHN SW 4014 is a true innovation in bale wrapping. The "drive-through" design allows wrapping of 2x3, 3x3, 2.5x4, 3x4 and 4x4 (60x90, 90x90, 75x120, 90x120, 120x120 cm) large square bales, as well as round bales up to 4' (120 cm) in diameter. This versatile wrapper features a unique AutoLoad function for nonstop fully automatic wrapping.

### AUTOLOAD: HOW DOES IT WORK?

AutoLoad is based on Category II Laser technology. The laser sensor, situated inside the top cover at the front side of the machine, scans the area ahead of the bale wrapper. In addition, a wheel sensor is placed on the left wheel which measures the speed and distance toward the bale.

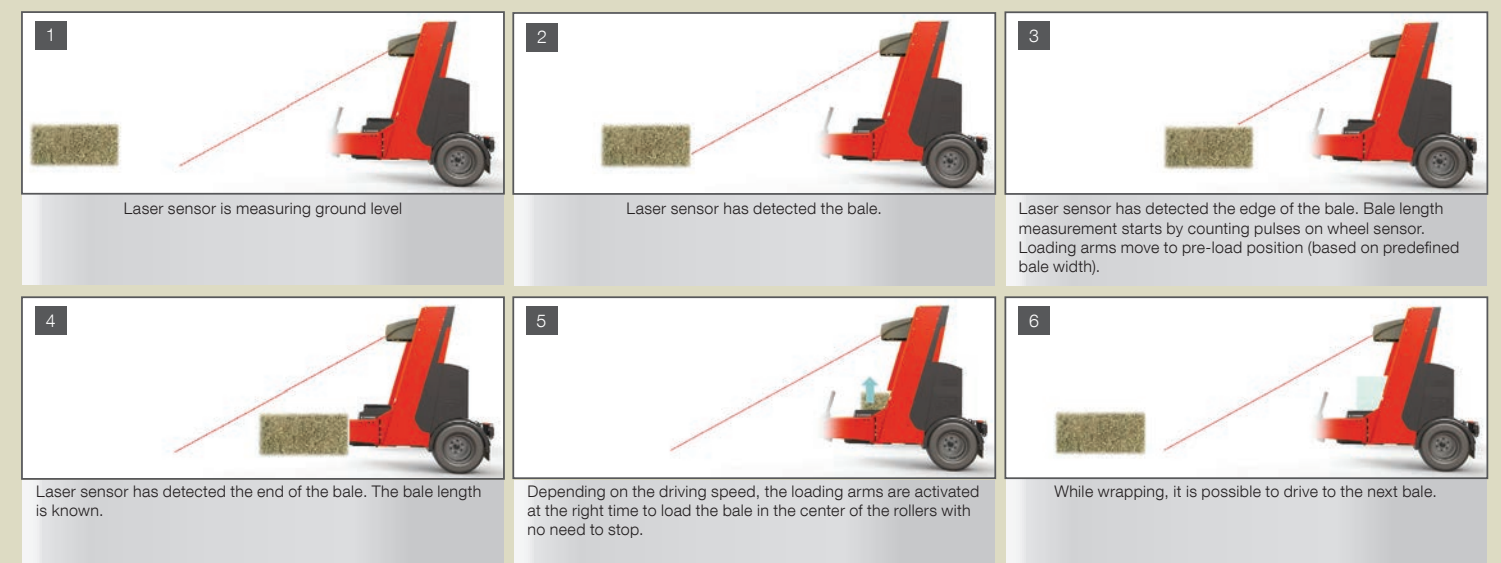

In case bales are dropped in ditches, under fences or even in corners of the field, the SW 4014 AutoLoad still allows you to load bales manually, forwards and backwards.

\* AutoLoad parameters: 1) Square bale length must be between 29 and 79 inches (74 and 200 cm). 2) Driving speed must be constant and between 0.25 and 2.5 mph (0.4 and 4.0 kph) during scanning and loading.



**OUTSTANDING STABILITY**

Thanks to its solid design, with incorporated hydraulic sliding frame, an extremely wide track is achieved for outstanding stability of the machine. This unique “drive through” operation enables easy loading of the bale and excellent visibility of the wrapping process. The SW 4014 has an operational width of 13' (4 m) in the field and only 8' (2.5 m) during transport.



**OPTIMAL VERSATILITY**

The SW 4014 is capable of wrapping large square and round bales up to 3,300 pounds (1,500 kg). Wrapping of round bales is possible without any additional equipment or mechanical adjustments. All predefined bale dimensions can easily be selected via the monitor.



**EXCEPTIONAL BALE HANDLING**

The smart design of the SW 4014 guarantees easy loading and unloading of the bales, front- and backwards, even when dropped in hard-to-reach locations. All bales are loaded and unloaded without the risk of damage or soil contamination because of the two pairs of steel rollers.

**EXCELLENT WRAPPING**

The positioning of the shorter top rollers allow the film roll holders to be positioned as low as possible. As a result, the film is wrapped closer to the center of the bale with less wrinkling, ensuring an optimum oxygen barrier for excellent feed quality.



Greater management and control of the wrapping process can be achieved by our unique IntelliWrap feature. IntelliWrap uses sophisticated electronics and hydraulics to monitor the wrapping process and continuously controls the film overlap, allowing total flexibility. Depending on local circumstances, crop conditions and storage periods, the amount of film layers (4, 5, 6, 7, 8, 9...) can be easily adjusted. An excellent distribution of the film around the bale and precise overlap of the film provides maximum efficiency and increased feed quality.

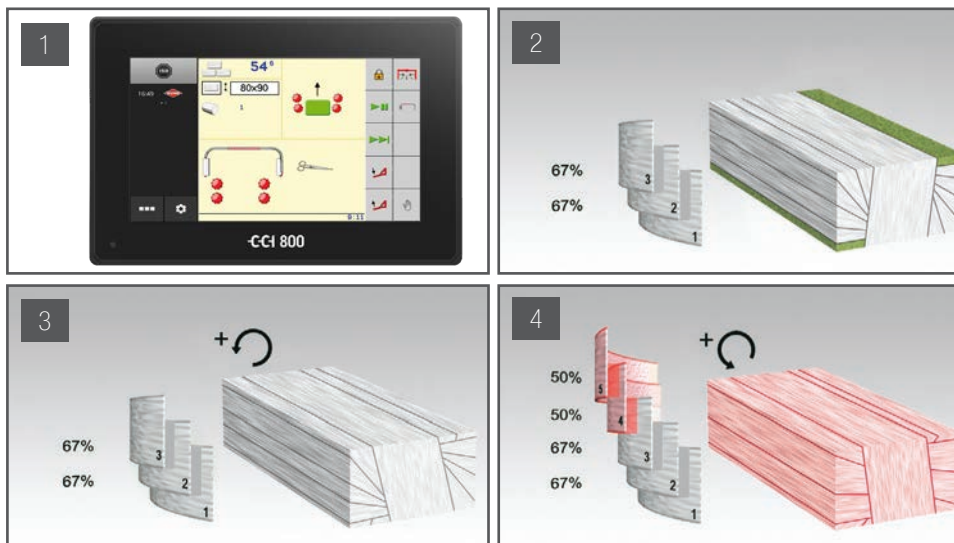

1. Selection of five film layers
2. The bale is covered with three layers and 67% overlap
3. Increasing of the bale rotational speed
4. Final two layers with 50% overlap

**FUEL SAVINGS**

The SW 4014 can be operated with a broad range of tractors because of a limited oil flow requirement of 11 gallons/min (40 liters/min). As an option, the wrapper can be equipped with a PTO driven oil supply for optimal wrapping capacity. The tractor can run at lower engine rpm for significant fuel savings. Further fuel savings can be achieved by running on 540E / 750 rpm PTO speed. In addition, the PTO driven oil supply is a closed system and there is no risk of oil contamination from different tractors.



**MAINTENANCE AND ACCESSIBILITY**

The large side doors of the SW 4014 provide excellent accessibility for maintenance. The SW 4014 can be equipped with an optional LED work light for a better view of the wrapping process in the dark.



**WHEELS & COVERS**

To prevent film damage during transport, the SW 4014 is fitted with large wheel covers. 380/55x17 wheels are standard.



# ALWAYS IN CONTROL

The SW 4014 is ISOBUS compatible. ISOBUS compatible tractors will therefore not require a separate terminal for the wrapper. Alternatively, a CCI 800 or CCI 1200 monitor can be used with tractors that are not ISOBUS compatible. Operator settings, such as selecting predefined bale dimensions and switching from transport into field mode are accessed via the monitor. Information such as wrapping process overview and number of bales is also provided.

**CCI 800**

The CCI 800 has an 8" (20.3 cm) large working screen for a more compact terminal with automatic brightness adjustment for better visibility in the cab. Despite its compact size, you are able to view more apps and machine information than before with the terminal's MiniView display on the left side of the screen. The CCI 800 has been ISOBUS certified by the AEF.

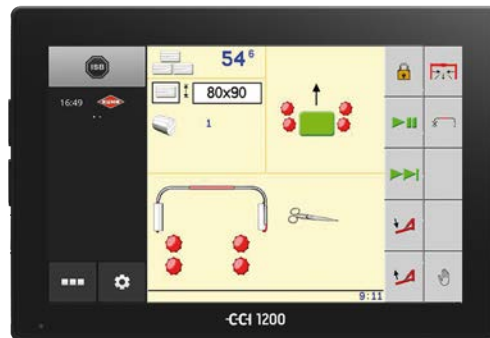

**CCI 1200**

The ISOBUS CCI 1200 terminal provides increased performance, improved visibility and more flexibility. Its large touchscreen allows multiple display configurations for matching operator preference for various information. The end result is a terminal with a 12.1" (30.7 cm) touchscreen that enables the simultaneous display of all information essential for the operator. The anti-glare screen provides excellent visibility, even when the sun is shining. The CCI 1200 has been developed by several manufacturers of agricultural machinery within the CCI association.

**WORKING CONVENIENCE**

To provide optimal working convenience, the SW 4014 has a smart feature that enables you to choose (automatic) unloading of bales in a selected position. You can choose to unload the bale with the knots on top for easier twine removal and also quicker access to your feed after unwrapping the bale. Or if required, you can unload on the short side for easy transport.



Technical Specifications	RW 1110 Series	
	RW 1110 M	RW 1110 C
Bale size (width x diameter)	4' x 3'-5" (1.2 m x 0.9-1.5 m)	
Maximum bale weight	2,645 lbs (1,200 kg)	
Transport width	7'10" (2.4 m)	
Transport height	8'6" (2.6 m)	
Hitch	Cat. 2 (quick hitch compatible as standard)	
Loading system	External	
Wrapping table	4 belts + 2 rollers	
Bale support roller	2 adjustable rollers	
Control	(M) Manual 2 lever cable controlled	(C) Computer controlled (VT 30)
Automatic stop by end of film / tear	-	Standard
RF remote control (rechargeable)	-	Standard
Fully automatic film cutter	Sure grip as standard	
Film pre-stretcher	Standard 30" (75 cm) Optional kit for 20" (52 cm)	
Pre-stretch ratio	Approx. 70% standard, Optional 60%	
Required tractor hydraulic connections	1 SA with free return or 1 DA	
Output and pressure required	7 gpm at 2,200 psi	
Machine net weight	1,985 lbs (900 kg)	

Technical Specifications	RW 1410 Series	
	RW 1410 M	RW 1410 C
Bale size (width x diameter)	4' x 3-5' (1.2 m x 0.9-1.5 m)	
Maximum bale weight	2,200 lbs (1,000 kg)	
Transport width	8'1" (2.45 m)	
Transport height	8'11" (2.7 m)	
Loading system	Loading arm	
Ability to carry second bale on loading arm	N/A	
Wrapping table	4 belts + 2 rollers	
Bale support roller	2 adjustable rollers	
Control	(M) Manual 3 lever cable controlled	(C) Computer controlled (VT 30)
Semi-automatic operation of (M) version by bale and wrap counter and automatic table stop	Standard	
Automatic stop by end of film / tear	-	Standard
RF remote control (rechargeable)	-	Optional
Fully automatic film cutter	Standard	
Film pre-stretcher	Standard 30" (76 cm) - optional kit for 20" (51 cm)	
Pre-stretch ratio	Approx. 70% standard / 90% E-twin Optional 60 %	
Required tractor hydraulic connections	1 SA with free return or 1 DA	
Output and pressure required	7 gpm at 2,200 psi	
Road lights	Optional	
Tires	10.0/80-12	
Ability to turn wheels inside for road transport	Right side swivels, left side is fixed	
Machine net weight	2,200 lbs (1,000 kg)	

Technical Specifications	RW 1610 Series	
	RW 1610 M	RW 1610 C
Bale size (width x diameter)	4' x 3-5' (1.2 m x 0.9-1.5 m)	
Maximum bale weight	Standard 2,200 lbs (1,000 kg) - optional 2,650 lbs (1,202 kg)	
Transport width	8'10" (2.7 m)	
Transport height	8'8" (2.6 m)	
Loading system	Loading arm	Standard autoloader
Ability to carry second bale on loading arm	Standard	
Wrapping table	4 belts + 2 rollers	
Bale support roller	2 adjustable rollers	
Control	(M) Manual 3 lever controlled	(C) Computer controlled (VT 30)
Semi-automatic operation of (M) version by bale and wrap counter and automatic table stop	Standard	-
Automatic stop by end of film / tear	-	Standard
RF remote control (rechargeable)	-	Optional
Fully automatic film cutter	Standard	
Film pre-stretcher	Standard 30" (76 cm) - optional kit for 20" (51 cm)	
Pre-stretch ratio	Approx. 70% standard / 90% E-twin Optional 60%	
Required tractor hydraulic connections	1 SA with free return or 1 DA	
Output and pressure required	7 gpm at 2,200 psi	
Road lights	Standard	
Tires	Standard 380/55x17	
Ability to turn wheels inside for road transport	N/A	
Machine net weight	3,285 lbs (1,490 kg)	

Technical Specifications	SW Series			
	SW 1114 M	SW 1114 C	SW 1614 M	SW 1614 C
Large square bale size - width x height x length	2x3 or 3x3 bales up to 6' long (0.6x0.9 or 0.9x0.9 m bales up to 1.8 m long)			
Round bale size - width x diameter	(4-5)' x (3-5)' ((1.2 - 1.5 m) x (0.9 - 1.5 m))		(4-5)' x (3x5)' (1.2-1.5 m x 0.9-1.5 m)	
Maximum bale weight	2,650 lbs (1,202 kg)		Standard 1,770 lbs (803 kg) - optional 2,200 lbs (1,000 kg)	
Transport width	9'5" (2.9 m)		8'2" (2.5 m)	
Transport height	8'6" (2.6 m)		9'3" (2.8 m)	
Hitch	Cat. 2 (quick hitch compatible as standard)		-	
Loading system	Non self-loading		Parallel loading arm	Standard autoloader
Ability to carry second bale on loading arm	-		Standard	
Ability to wrap round bales	Standard			
Wrapping table	Adjustable twin roller pair configuration			
Bale support roller	2 adjustable rollers			
Control	(M) Manual 2 lever controlled	(C) Computer controlled	(M) Manual 3 lever/cable controlled	(C) Computer controlled
Automatic stop by end of film / tear	-	Standard	-	Standard
RF remote control (rechargeable)	-	Standard	-	Optional
Fully automatic film cutter	Standard hydraulic			
Film pre-stretcher	Standard 30" (46 cm) - optional 20" (51 cm)		Standard 30" (76 cm) - optional 20" (51 cm)	
Pre-stretch ratio	Approximately 70% standard - 60% optional			
Required tractor hydraulic connections	1 SA with free return or 1 DA			
Output and pressure required	7 gpm at 2,200 psi			
Road lights and signaling	Optional with trailer kit		Standard	
Tires	-		15.0/55-17	
Ability to turn wheels inside for road transport	-		Manual standard / hydraulic option	
Machine net weight	2,250 lbs (1,021 kg)		3,375 lbs (1,531 kg)	

Technical Specifications	SW 4014
	SW 4014
Large square bale size - width x height x length	2x3, 3x3, 3x4, or 4x4 bales up to 6'6" long (0.6 x 0.9 m, 0.9 x 0.9 m, 0.9 x 1.2 m, or 1.2 x 1.2 m bales up to 2 m long)
Round bale size - width x diameter	4'-5' x 3'-4'10" (1.2-1.52 m x 0.9-1.5 m)
Maximum bale weight	3,300 lbs (1,500 kg)
Length	Without PTO driven hydraulics: 15'5" (4.7 m), With PTO driven hydraulics: 17' (5.1 m)
Transport width	8'2" (2.5 m)
Transport height	9'2" (2.8 m)
Hitch	Cat. 2 swivel headstock
ISOBUS certified wrapper table with IntelliWrap	Standard
Loading system	Twin roller arms
Bale alignment adjustment	Hydraulically shift wrapper for proper alignment with bale
Ability to wrap round bales	Standard
Wrapping table	Electronic controlled 2x2 roller pair
Bale auto-levelling for wrapping and unloading	Standard
Control	No monitor standard; optional CCI 50, CCI 800 or CCI 1200 ISOBUS monitor
Satellite arm	Twin satellite arm
Kit for 1/2 table speed to work with one pre-stretcher	Standard on monitor (activated automatically if equipped with optional film break sensor)
Automatic stop by end of film / tear	Standard
Film pre-stretcher	Standard 30" (76 cm)
Pre-stretch ratio	Standard 60% - Optional 70%
Required tractor hydraulic connections	1 SA with 3/4" free turn
Output and pressure required	Standard 11-16 gpm at 2,600 psi
PTO driven hydraulics	Optional
Road lights and signaling	Standard
Tires	Standard 380/55X17
Machine net weight	6,220 lbs (3,003 kg)

# MyKUHN

THE LINK TO MY SUCCESS

MyKUHN is your online customer portal where you can access machine operator's manuals, parts catalog and more! The site is available on computer, phone or tablet, so you can access your fleet's information anywhere around the farm. Create an account and register your KUHN equipment today!



## MORE PRODUCTS TO MEET YOUR NEEDS!



1. Mowers - 2. Tedders - 3. Round Balers - 4. Bale Processors - 5. Manure Spreaders - 6. Primary Tillage Systems

KUHN NORTH AMERICA, INC. | Corporate Headquarters | 1501 West Seventh Avenue - Brodhead, WI 53520

For more information about your nearest KUHN dealer,  
visit our website [www.kuhn.com](http://www.kuhn.com)

Information given in this document is only for informational purposes and is non-contractual. Our machines are in compliance with North American safety standards. In our literature, and for improved illustration of certain details, some safety devices may not be in operating position. When operating these machines, these devices must be operated in accordance with the requirements indicated in the operator's manuals and assembly manuals. We reserve the right to change any designs, specifications or materials listed without further notice. Machines and equipment in this document can be covered by at least one patent and/or registered design. Trademarks cited in this document may be registered in one or several countries.

Printed in USA 706467US 0222 Copyright 2022 Kuhn North America, Inc.

