

COMBINE GRAIN TANK EXTENSION

9E000013 - IH 2144 Long Auger Extension

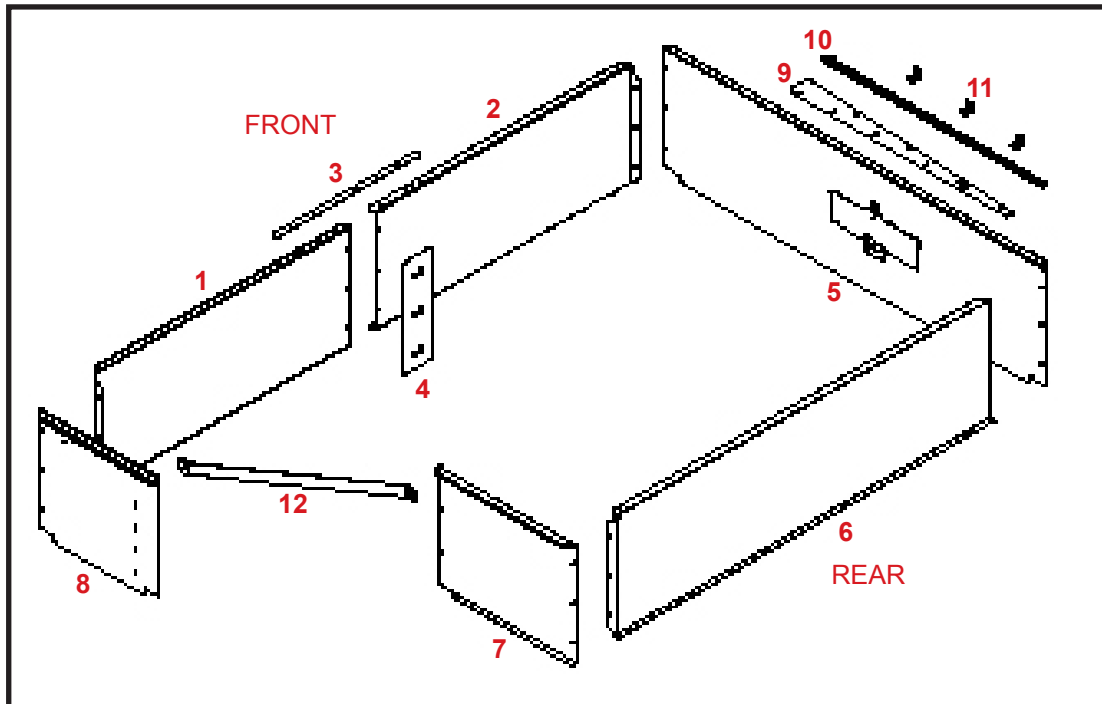

Figure 1

PARTS LIST

Please order replacement parts by PART NO. and DESCRIPTION.

REF.#	PART #	QTY.	DESCRIPTION
1.	R3E000079S0	1	2144 Left Front Panel
2.	R3E000080S0	1	2144 Right Front Panel
3.	R3E000083S0	1	2144 Front Splice Strap
4.	R3E000084S0	1	2144 Front Splice Plate
5.	R3E000081S0	1	2144 Right Panel
6.	R3E000082S0	1	2144 Rear Panel
7.	R3E000077S0	1	2144 Left Side Rear Panel
8.	R3E000076S0	1	2144 Left Side Front Panel
9.	R3E000085S0	1	2144 Elevator Surround
10.	R3E000088S0	1	2144 Rubber Seal 45"
11.	R3E000087S0	3	2144 Elev. Seal Bracket
12.	R3E000078S0	1	2144 Left Panel Strap
13.	1AFC37E00L0	49	5/16" x 3/4" Serrated Flng. Bolt
14.	1AFC08E0000	49	5/16" Serrated Flng. Nut
15.	1AFC37D00H0	9	1/4" x 1/2" Serrated Flng. Bolt
16.	1AFC08D0000	9	1/4" Serrated Flng. Nut

STEP 1:

Remove any factory tank boards from the grain tank.

STEP 2:

Fasten both the front left (# 1) and front right (# 2) panels to the top front lip of the grain tank using 5/16" x 3/4" bolts and 5/16" nuts. Connect the panels together with the provided splice plate (# 4) using 5/16" x 3/4" bolts and 5/16" nuts.

STEP 3:

Once the splice plate has been secured to both front panels finish by fastening the splice strap (# 3) to the under side of the top lip of the front panels using 5/16" x 3/4" bolts and 5/16" nuts.

STEP 4:

Fasten the rear panel (# 6) to the top rear lip of the grain tank using 5/16" x 3/4" bolts and 5/16" nuts.

STEP 5:

Remove both the door and latch from the clean grain elevator head.

STEP 6:

Loosen the bolts on the tank side of the bracket, between the elevator head and the tank side. Install the right side panel (# 5) to the previously installed right front panel and rear panel using 5/16" x 3/4" bolts and 5/16" nuts. Right panel will slide behind the elevator bracket.

STEP 7:

Fasten the left front side panel to the previously installed left front panel using 5/16" x 3/4" bolts and 5/16" nuts.

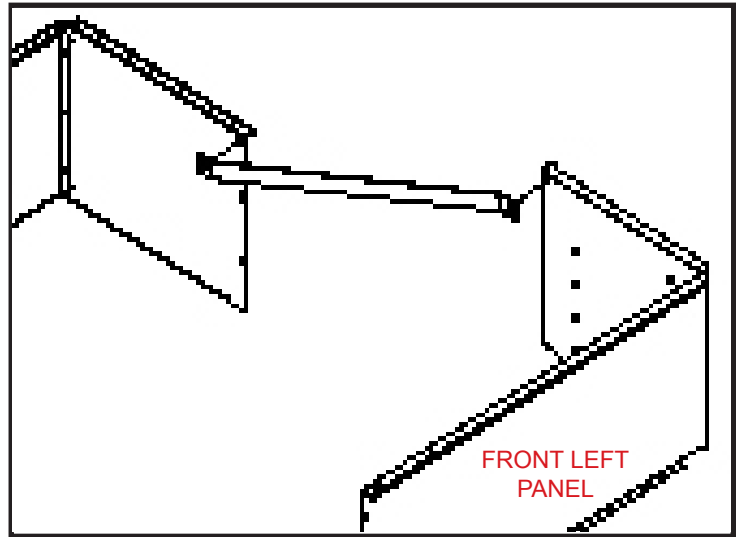

Figure 2

STEP 8:

Fasten the left rear side panel to the previously installed rear panel using 5/16" x 3/4" bolts and 5/16" nuts.

STEP 9:

Secure the left panel strap (# 12) to both the front and rear left side panels over the top of the unloading auger brace. Use 5/16" x 3/4" bolts and 5/16" nuts. See figure 2.

STEP 10:

Attach the provided rubber seal to the elevator surround (# 9) by slipping the metal clip end of the seal over the edge with three slots on it. Contour the elevator surround to the elevator head and secure using 1/4" x 1/2" bolts and 1/4" nut. Next bolt the elevator surround piece to the right extension panel by using the three elevator surround brackets (# 11). (Fasten the seal brackets to the elevator surround first and then to the right panel) Mark the position of the brackets, and drill three 5/16" holes in the right panel to accommodate the brackets. Some adjustment may be necessary in order to get the rubber seal to seat tight on the panel. See figure 3.

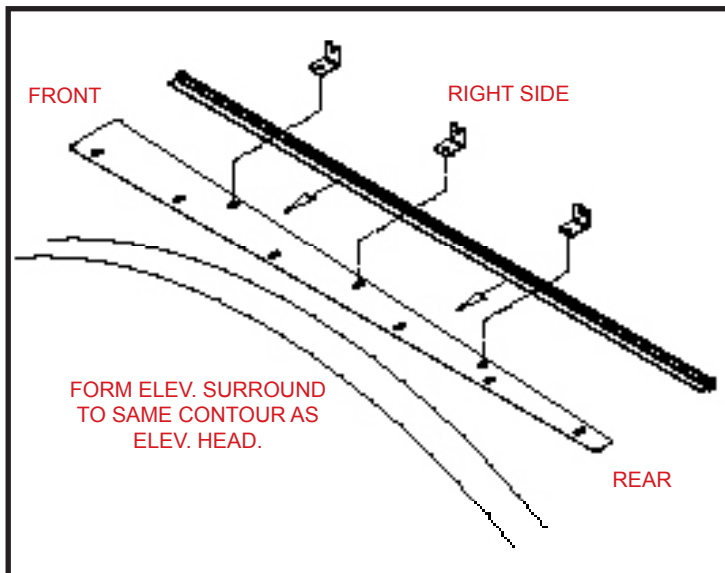

Figure 3